



Rayleigh Road, Palmer Green, London, N13
Chain Free £500,000 Freehold

Anthony Webb
ESTATE AGENTS

Rayleigh Road, Palmer Green, London, N13

Chain free 1930s built extended three bedroom terrace house requiring modernisation. The property offers great potential to extend and improve to create a wonderful family home

Rayleigh Road is a quiet residential turning located off The Fairway within easy reach of local shops and Palmers Green's shops, restaurants, bus routes and mainline station into Moorgate. Firs Farm Wetlands park and popular primary school are also a short walk away.

Hallway • Through lounge • Galley kitchen • Extended sitting/utility area • First floor landing with access to loft space • Two double bedrooms both with fitted wardrobes • Single bedroom • Bathroom • Double glazing • Gas central heating • Front garden with potential for off street parking • Rear garden

Enfield Council Tax band E

- Three bedrooms
- 1930s built terrace house
- Through Lounge
- Galley kitchen
- Rear extension/utility area
- First floor bathroom
- Double glazing/gas central heating
- Front and rear gardens





Rayleigh Road
Palmer Green
London
N13 5QW

Tenure: Freehold
Gross Internal Area: 856.00 sq ft

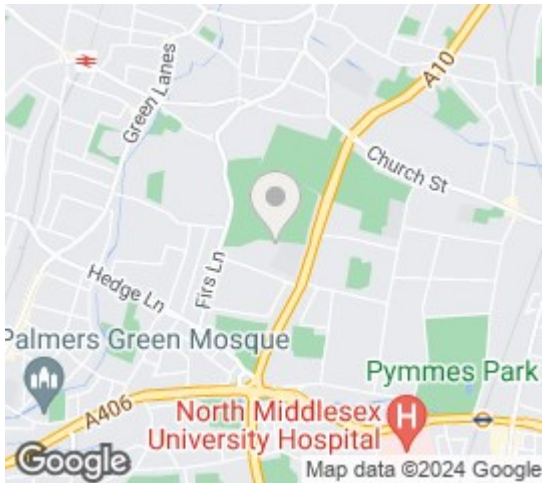

Energy Efficiency Rating		Current	Potential
Very energy efficient - lower running costs			
(92 plus) A			88
(81-91) B			
(69-80) C		70	
(55-68) D			
(39-54) E			
(21-38) F			
(1-20) G			
Not energy efficient - higher running costs			
England & Wales		EU Directive 2002/91/EC	
Environmental Impact (CO ₂) Rating		Current	Potential
Very environmentally friendly - lower CO ₂ emissions			
(92 plus) A			
(81-91) B			
(69-80) C			
(55-68) D			
(39-54) E			
(21-38) F			
(1-20) G			
Not environmentally friendly - higher CO ₂ emissions			
England & Wales		EU Directive 2002/91/EC	

Rayleigh Road,
Palmer's Green, N13 5QW
Approx. Gross Internal Area 856 Sq Ft - 79.51 Sq M

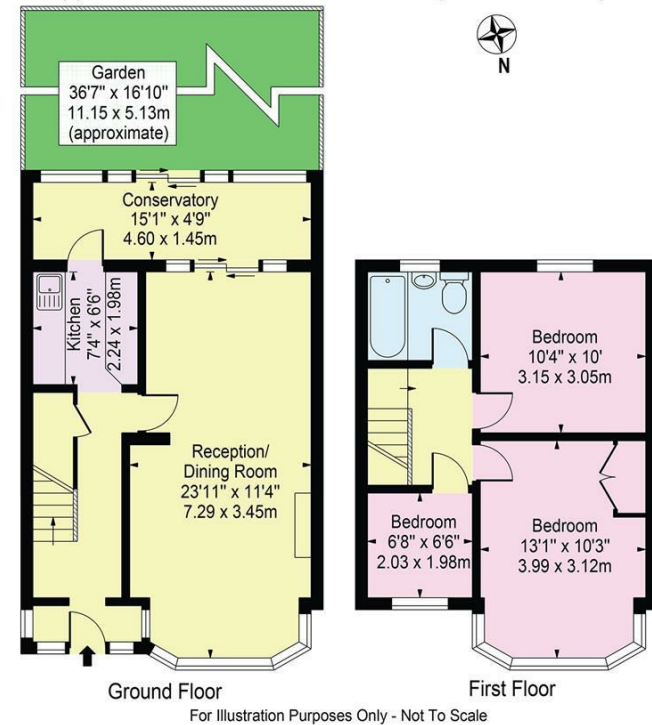

This floor plan should be used as a general outline for guidance only and does not constitute in whole or in part an offer or contract. Any intending purchaser or lessee should satisfy themselves by inspection, searches, enquiries and full survey as to the correctness of each statement. Any areas, measurements or distances quoted are approximate and should not be used to value a property or be the basis of any sale or let.

Property particulars as supplied by Anthony Webb Estate Agents are set out as a general outline in accordance with the Property Misdescriptions Act (1991) only for the guidance of intending purchasers of lessees, and do not constitute any part of an offer or contract. Details are given without any responsibility, and any intending purchasers, lessees or third parties should not rely on them as inspection or otherwise as to the correctness of each of them. We have not carried out a structural survey and the services, appliances and specific fittings have not been tested. All photographs, measurements, floor plans and distances referred to are given as a guide only and should not be relied upon for the purchase of carpets or any other fixtures statements or representations of fact, but must satisfy themselves by or of fittings, gardens, roof terraces, balconies and communal gardens as well as tenure and lease details cannot have their accuracy guaranteed for intending purchasers. Lease details, service ground rent (where applicable) are given as a guide only and should be checked and confirmed by your solicitor prior to exchange of contracts. no person in the employment of Anthony Webb has any authority to make any representation or warranty whatever in relation to this property.

348 Green Lanes, Palmers Green, London N13 5TJ
020 8882 7888
palmersgreen@anthonywebb.co.uk
anthonywebb.co.uk

Anthony Webb
ESTATE AGENTS